

Techno Cooper Cameron Check Valves



MULTI-PURPOSE CHECK VALVES FOR INDUSTRY DESIGN FEATURES:

Unrestricted Full Port Seatless Design

- Maximum Flow Area
- Minimum Pressure Drop

Elimination of Metal-to-Metal Rotating Parts

- No Pins to Wear
- No Seats to Wear
- No Routine Maintenance
- No Spring to Break

Non Slam Quick Closure Feature

- Minimum Travel of Valve Plates from Full Open to Full Closed Position Reduces Closing Time
- Elimination of Spring Restricts "slamming" action

Tight Shut-Off Feature

- Flexible Elastomer Provides Perfect Seal
- Seals Tightly at Extremely Low Back Pressure

CAN BE MOUNTED IN ALMOST ANY POSITION

Male Threaded Ends
and Smooth Plain Ends

Threaded End- PIPE SIZE- Sch 40

Standard valves are either Aluminum or 316 Stainless Steel / Silicone Seat Material (-100°F to 500°F)

	A	B	C
2" NPT Threaded End	4"	2.375"	2.75"
2.5" NPT Threaded End	5"	2.875"	3.25"
3" NPT Threaded End	5.5"	3.5"	3.875"
4" NPT Threaded End	6"	4.5"	4.875"
5" NPT Threaded End	7"	5.5625"	6.125"
6" NPT Threaded End	8"	6.625"	7.125"
8" NPT Threaded End	10"	8.625"	9.5"
10" NPT Threaded End	12"	10.75"	11.5"

Plain (Smooth) End- PIPE SIZE- Sch 40

Standard valves are either Aluminum or 316 Stainless Steel / Silicone Seat Material (-100°F to 500°F)

	A	B	C
2.375" OD Plain End	5.75"	2.375"	2.75"
2.875" OD Plain End	5.75"	2.875"	3.25"
3.5" OD Plain End	5.75"	3.5"	3.875"
4.5" OD Plain End	6.75"	4.5"	4.875"
5.5625" OD Plain End	7.75"	5.5625"	6.125"
6.625" OD Plain End	8.75"	6.625"	7.125"
8.625" OD Plain End	10.75"	8.625"	9.5"
10.75" OD Plain End	12.75"	10.75"	11.5"

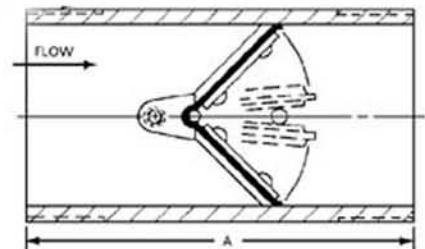
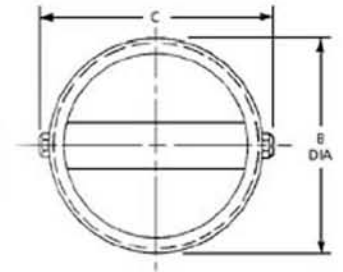

Advanced Industrial Design, Inc.
Powder and Bulk Materials Handling

Website: www.aid-inc.com
Contact Us At: info@aid-inc.com
Phone: (866) 439-6999